

Paloma WD

29.05.2020

Christian VUILLAMOZ
Olivier BEUTLER

Table of Contents

Design / Description

News / Highlights

USP's

Combinations

Definitions IP (Ingress Protection)

Design / Description

Vision system

For product localization and quality controls

HMI touch panel

Easy to use and intuitive recipe programming with GEMINI 5

Control cabinet on top

For good visibility and easy access to products areas

Stainless steel frame

High grade stainless steel 304 for 2 or 3 robots configurations

End-effectors

Hygienic grippers or vacuum system for gentle handling of various products type

Washdown conveyors

Infeed of products
Outfeed to various packing machines

Stainless steel Delta Robot IP69K

For high speed pick / place



Delta Robot GD40 WD



Specifications :

- Cleaning : high pressure up to 28bar, IP69K
- Rotatory axes: 1, telescopic shaft
- Max. rotation of the rotatory axe: unlimited
- Standard flange for tool connection
- Diameter working space: 1065 mm
- Height of working space: 330 mm (465 mm)
- Nominal payload: 1 kg, up to 2 kg
- Robot weight: 107 kg
- Material : stainless steel (upper arms), titan (forearms), PEEK (tool plate)



Hygienic design - To be easy to clean

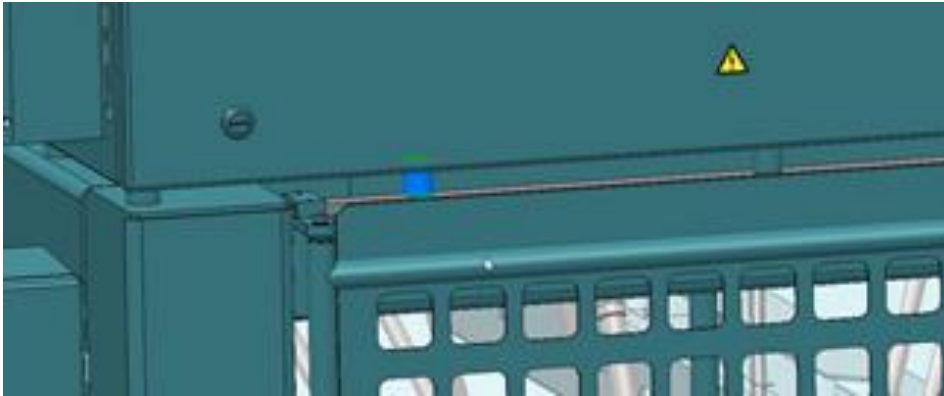

All surfaces in contact with products are easily accessible for visual inspection and manual cleaning.

According to the EHEDG (European Hygienic Engineering & Design Group) guidelines.

Avoid large flat surfaces in contact or surfaces with a small interface distance by adding spacers.

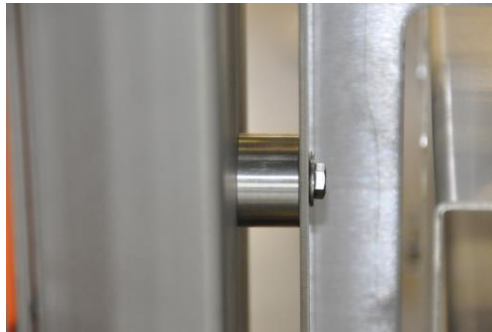

Cleanable with water on all areas of the machine (1/3)

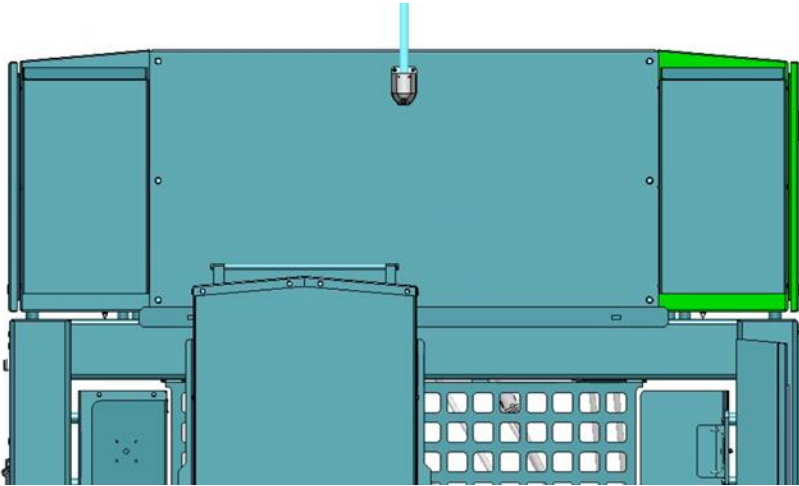

Avoid flat surfaces and eliminate retention areas.

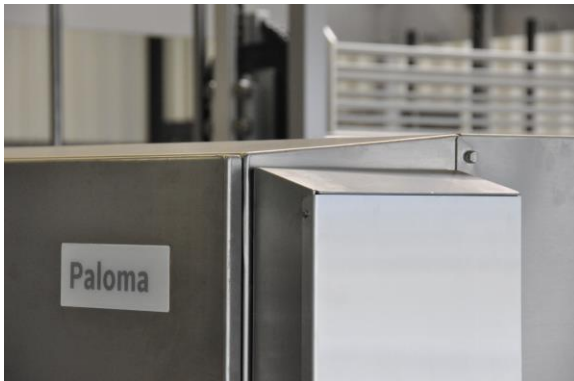

Waterproof HMI with IP65 enclosure



Cleanable with water on all areas of the machine (2/3)



Vision box fully washable inside the vision enclosure thanks to IP rate of selected components :

- with IP69K camera
- Waterproof LED bars (IP67)



Cleanable with water on all areas of the machine (3/3)

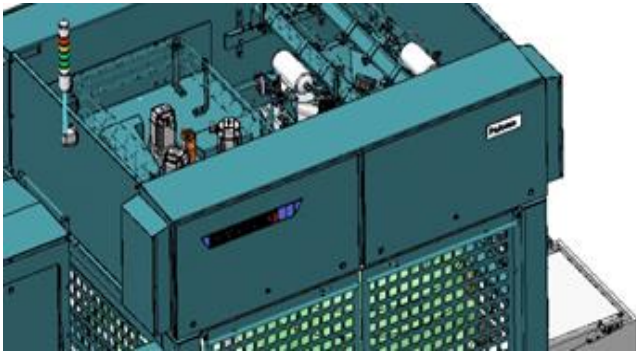

Electrical cabinet IP65

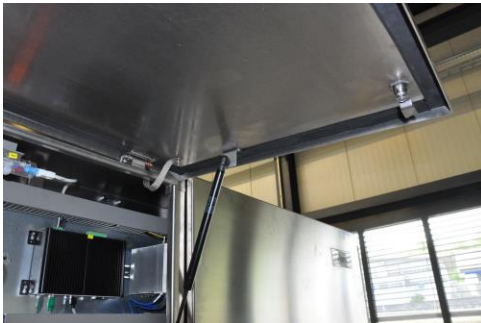
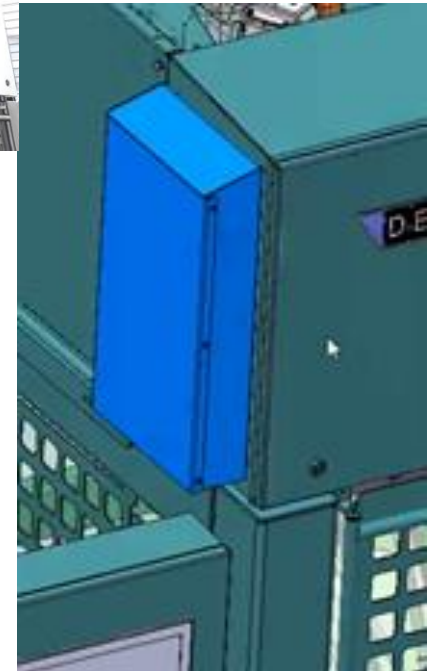

Cover to protect the ventilation air inlets of the electrical cabinet and with inside chicanes against bottom up water jet.

Conveyors Washdown



Retractable nose for band release



Suspension stirrups for washing and drying

USP's

Meets your hygiene requirements

Design for washdown class IP 65 (Robot IP69k)

Quality control integrated

High performance vision system

Evolutive combinations

Customized solution up to 2'000 products/min

Ideal for fresh and frozen products

I.g.pizza, fish, meat, dairy products, bakery, etc

Fast 'n easy cleaning machine

Open and easy access in the whole machine area --> High Production availability

High flexibility

Fast production changes, HMI easy to use, no aded tools needed for format changes

Layout

Paloma 2R WD, also existing in a 3 robots configuration

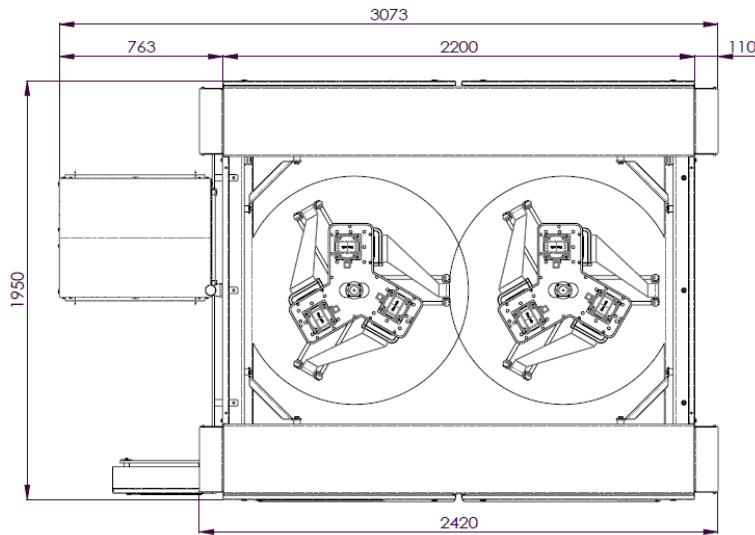

Top View

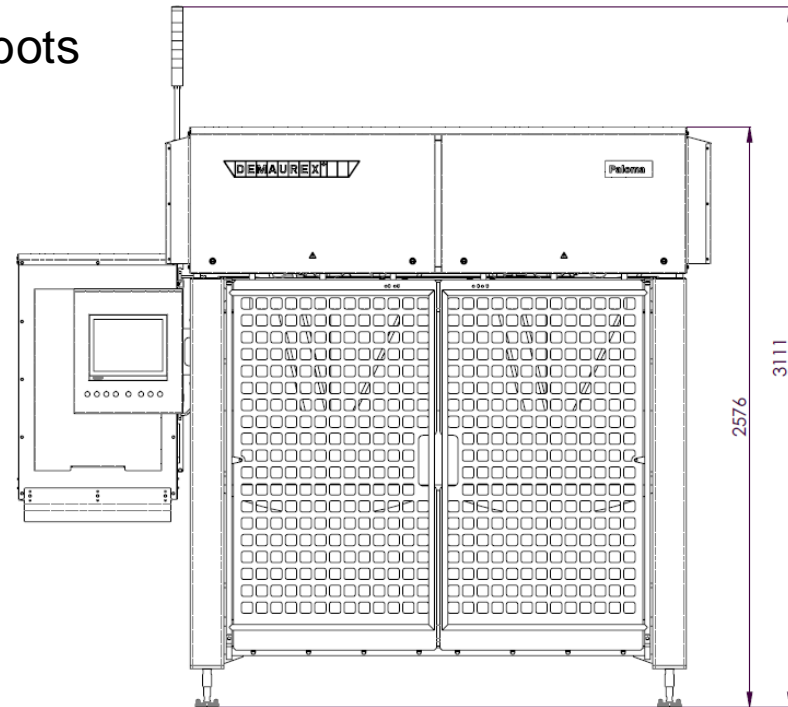

Front View

Combinations

Paloma 2R WD or Paloma 3R WD can be linked together to build a line.
Remark : in this case vision box is replaced by a removable extension frame.

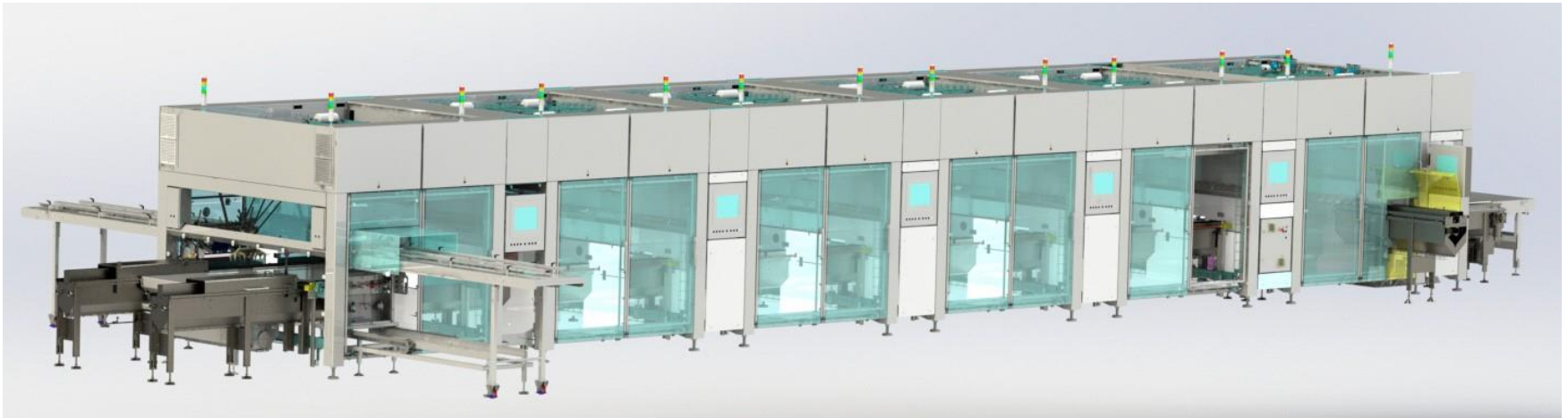

Ingress protection (IP) code

First digit indicates the level of protection that the enclosure provides against access to hazardous parts and the ingress of solid foreign objects.

The **second digit** indicates the level of protection that the enclosure provides against harmful ingress of **water**.

IP	Protection against	Details
5x	Dust protected	Ingress of dust is not entirely prevented, but it must not enter in sufficient quantity to interfere with the satisfactory operation of the equipment.
6x	Dust-tight	No ingress of dust; complete protection against contact (dust-tight). A vacuum must be applied. Test duration of up to 8 hours based on airflow.
65	Low pressure water jets	Water projected against enclosure from any direction shall have no harmful effects : 0.3 bar at distance of 3 meters
66	Powerful water jets	Water projected in powerful jets against the enclosure from any direction shall have no harmful effect : 1 bar at a distance of 3 meters.
66K	Powerful water jets with increased pressure	Water projected in powerful jets against the enclosure from any direction, under elevated pressure, shall have no harmful effects : 10 bars at distance of 3 meters.
67	Immersion, up to 1 meter depth	Ingress of water in harmful quantity shall not be possible when the enclosure is immersed in water under defined conditions of pressure and time : up to 1 meter of submersion during 30 minutes
68	Immersion, 1 meter or more depth	The equipment is suitable for continuous immersion in water under conditions which shall be specified by the manufacturer. However, with certain types of equipment, it can mean that water can enter but only in such a manner that it produces no harmful effects.
69K	Powerful high-temperature water jets	Protected against close-range high pressure, high-temperature spray downs.

Typical applications (fresh or frozen)



Meat
Fish
Pizza
Dairy products
Other fresh products

